



ICE CREAM HOUSING

MODULAR COMPONENTS

PROJECT _____

ITEM NO. _____

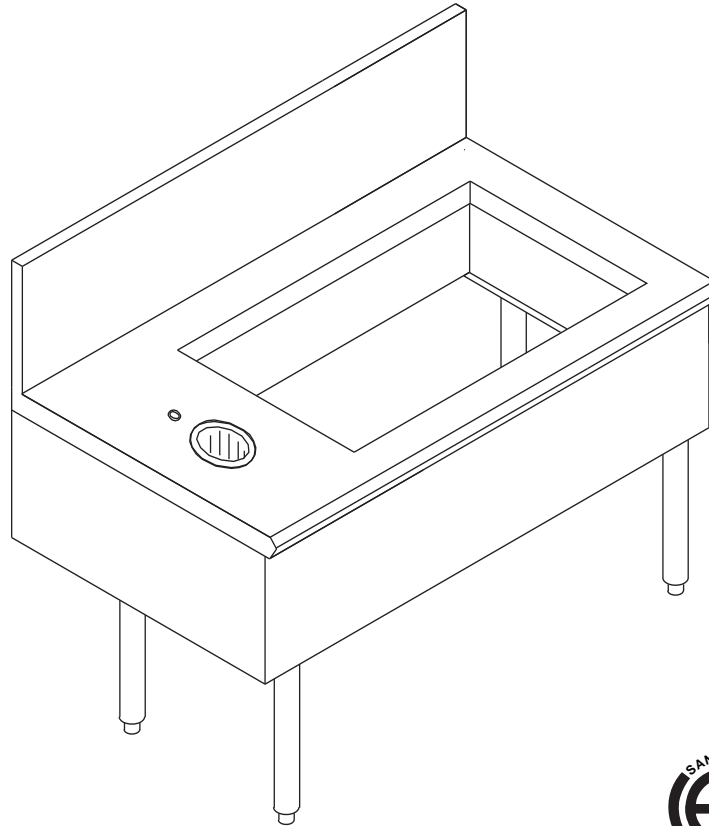

**Drop-in Ice Cream Station
Model IDKD-38**



STANDARD FEATURES

- All Heli-arc welded construction
- All 18 gauge type 304, 18/8 stainless steel
- Dipperwell and faucet
- Heavy duty stainless steel gussets welded to 14 gauge stainless steel channel supports
- Stainless steel adjustable bullet feet
- Provision for drop-in-freezer

MODELS

'S' SERIES 20.1/2" DEEP		
<u>Length</u>	<u>Ice Capacity</u>	<u>Model</u>
<input type="checkbox"/> 26"3 gallons	IDKS-26
<input type="checkbox"/> 38"6 gallons	IDKS-38
'D' SERIES 24" DEEP		
<u>Length</u>	<u>Ice Capacity</u>	<u>Model</u>
<input type="checkbox"/> 24"3 gallons	IDKD-3-26
<input type="checkbox"/> 36"6 gallons	IDKD-6-38

OPTIONS

- M Modified - Custom



ICE CREAM HOUSING

MODULAR COMPONENTS

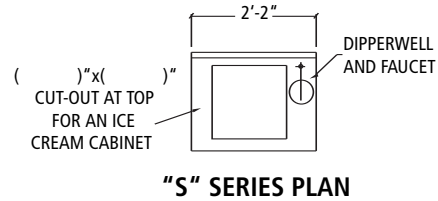
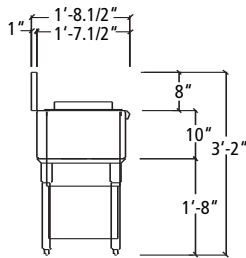
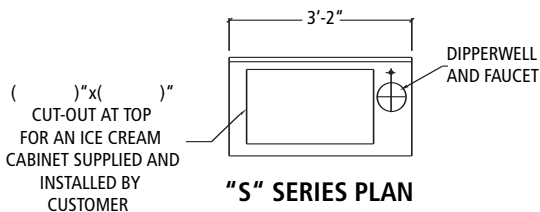
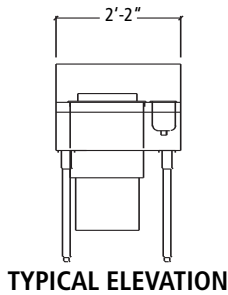
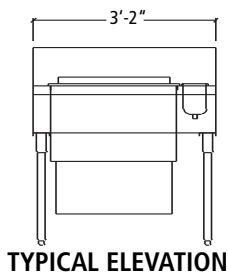
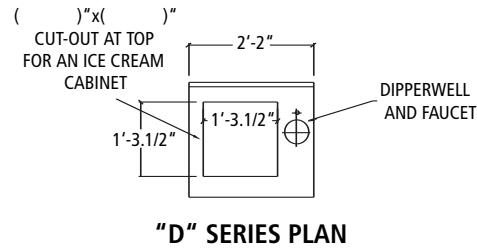
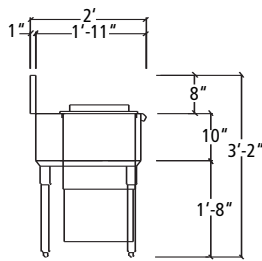
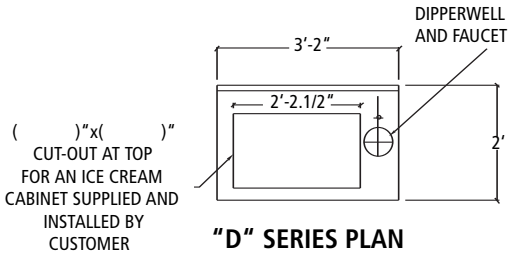

'S' SERIES 20.1/2" DEEP TOP ONLY			
LENGTH	MODEL No.	WEIGHT	CUBE
26	IDKS-26	65	8
38	IDKS-38	70	12

'D' SERIES 24" DEEP TOP ONLY			
LENGTH	MODEL No.	WEIGHT	CUBE
26	IDKD-26	70	8
38	IDKD-38	80	12

UTILITIES	
DRAIN	COLD WATER
1 x 1.1/2"	1/2"