



HAND SINK

MODULAR COMPONENTS

PROJECT _____

ITEM NO. _____

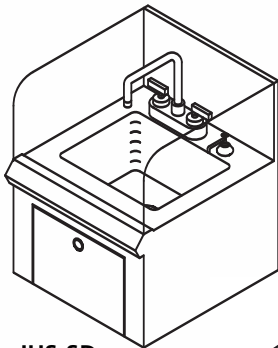

IHS-SD

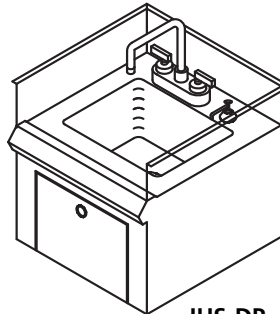

IHS-DP

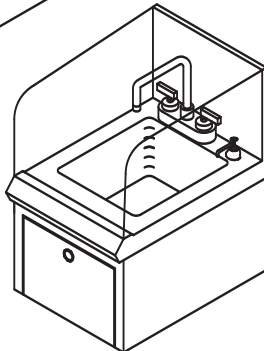

IHS-SS

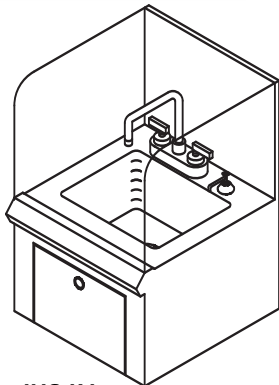

IHS-LV

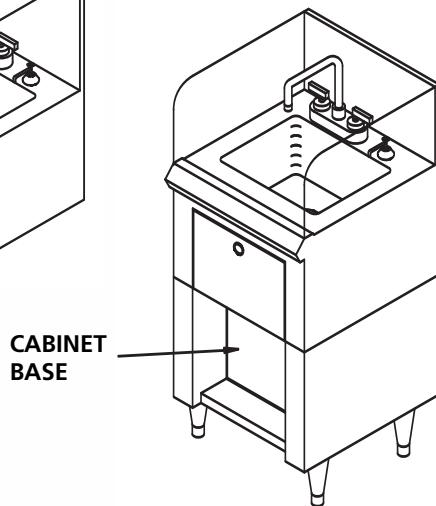

CABINET
BASE



CONFORMS TO
ANSI/NSF STD 2

MODELS

STANDARD

Length	Depth	Height	Model
<input type="checkbox"/> 15.1/2"17"12"IHS-SD

DROP-IN

Length	Depth	Height	Model
<input type="checkbox"/> 15.1/2"17"16"IHS-DP

SPACE-SAVER

Length	Depth	Height	Model
<input type="checkbox"/> 13"17"16"IHS-SS

LAS VEGAS

Length	Depth	Height	Model
<input type="checkbox"/> 15.1/2"17"16"IHS-LV

OPTIONS

- EEF Electric eye faucet
- SF Special brand faucet available upon request
- P "P" trap
- RS Rear s/s box spacer
(specify size when ordering)
- SMS Splash-mounted s/s soap dispenser
- FLG Front leg assembly (includes two
front legs w/ adjustable bullet feet)
- CAB Cabinet base
- KVF Knee valve
- FVF Foot valve faucet
- HBB Hose bib bracket
- HBBV Hose bib valve (w/mounting bracket)
- M Customized
- WS Without side splash
- WB Wrist blade handles

STANDARD FEATURES

- All Heli-arc welded construction
- All 18 gauge type 304, 18/8 stainless steel
- Exterior top, front apron, sides, back, backsplash, and bottom are 18 gauge, 304 series stainless steel.
- Pump action soap dispenser in rear deck
- Built-in "c-fold" towel dispenser
- Premium deck mount H/C faucet
- "Z" clip for attaching to wall
- Stainless steel side splashes



HAND SINK

MODULAR COMPONENTS

MODEL IHS-SD

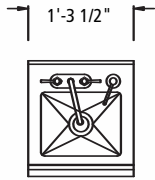

PLAN

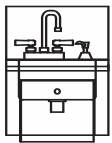

ELEVATION

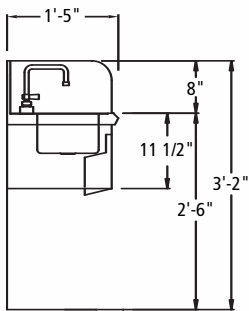

SECTION

MODEL IHS-DP

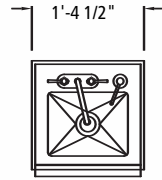

PLAN

15-5/8 x 15-5/8
(CUT OUT SIZE)

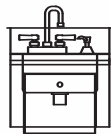

ELEVATION

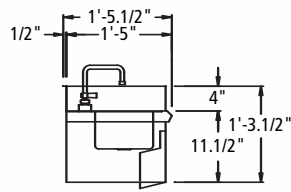

SECTION

MODEL IHS-SS

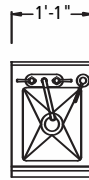

PLAN

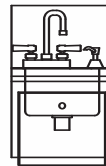

ELEVATION

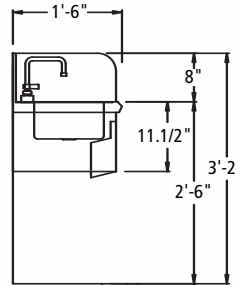

SECTION

MODEL IHS-LV

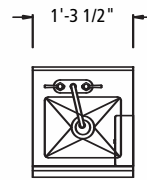

PLAN



ELEVATION

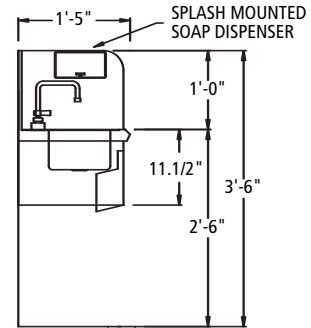

SECTION

HAND SINKS SELF CONTAINED

LENGTH	DEPTH	HEIGHT	MODEL No.	WEIGHT	CUBE
15.1/2"	17"	12"	IHS-SD	8	45

SPACE-SAVER HAND SINKS

LENGTH	DEPTH	HEIGHT	MODEL No.	WEIGHT	CUBE
13"	17"	16"	IHS-SS	8	45

HAND SINKS FOR COUNTER TOP INSTALLATION

LENGTH	DEPTH	HEIGHT	MODEL No.	WEIGHT	CUBE
15.1/2"	17"	16"	IHS-DP	8	50

LAS VEGAS HAND SINKS

LENGTH	DEPTH	HEIGHT	MODEL No.	WEIGHT	CUBE
15.1/2"	17"	16"	IHS-LV	8	45

UTILITIES

COLD WATER	HOT WATER	DRAIN
1 x 1/2" COLD	1 x 1/2" HOT	1 x 1.1/2"