



# 32" PLATE SHELF W/DRAWERS

## MODULAR COMPONENTS

PROJECT \_\_\_\_\_

ITEM NO. \_\_\_\_\_

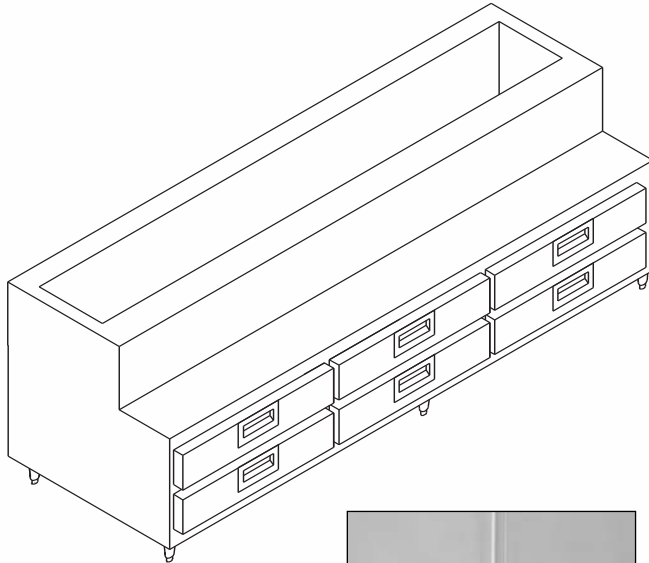

**INTEGRAL CENTER POSITION OF DRAWER PULL  
WITH POLISHED TRIM CENTER POSITION  
PREVENTS ROCKING OF DRAWER**



Detail of radius corner and tanked bottom

### STANDARD FEATURES

- All Heli-arc welded construction
- All 18 gauge 304, 18/8 stainless steel interiors front face doors and door backs
- Polyurethane 'shot-in-place' insulation
- 3/8" interior corners
- Polypropylene breaker strip is foamed-locked in-place using no mechanical fasteners
- High compression non-magnetic vinyl door/drawer gasket
- Flush front drawer-pull (built-into-the-face) is centered eliminating wracking of drawer
- Drawers each accommodates two full size pans side-by-side
- Pre-wired electrical conduit is internally installed within inner and outer walls
- Oversized blower coil with expansion valve, thermostat and solenoid valves
- Exclusive 14ga stainless steel drawer track system with 2" skate wheels

### MODELS

#### REMOTE LOW HEIGHT - 32" BODY HEIGHT ALL DRAWERS

Length	Depth	#Sections	Model
<input type="checkbox"/> 33.1/4"	32"	1	IPRR-1-02
<input type="checkbox"/> 63"	32"	2	IPRR-2-04
<input type="checkbox"/> 92"	32"	3	IPRR-3-06
<input type="checkbox"/> 121"	32"	4	IPRR-4-08

#### SELF CONTAINED LOW HEIGHT - 19" BODY HEIGHT ALL DRAWERS

Length	Depth	#Sections	Model
<input type="checkbox"/> 51"	32"	1	IPRS-1-02
<input type="checkbox"/> 81"	32"	2	IPRS-2-04
<input type="checkbox"/> 110"	32"	3	IPRS-3-06
<input type="checkbox"/> 139"	32"	4	IPRS-4-08

### OPTIONS

- F Freezer
- SSPR Stainless Steel Right End Panel
- SSPL Stainless Steel Left End Panel
- AS All Stainless Steel Including Ends, Back and Bottom
- ST Stainless Steel Top
- NC Night Covers
- CS Casters
- SSKW Stainless Steel Skate Wheels
- DPL Locking Padlock Assembly for Drawers
- DT Dual Temp. Base
- M Custom / Modified Unit
- MD3 MD3 Mega Drawer (Accommodates three Full Size Pans Side by Side)
- MG Magnetic Gasket



# 32" PLATE SHELF W/DRAWERS

MODULAR COMPONENTS

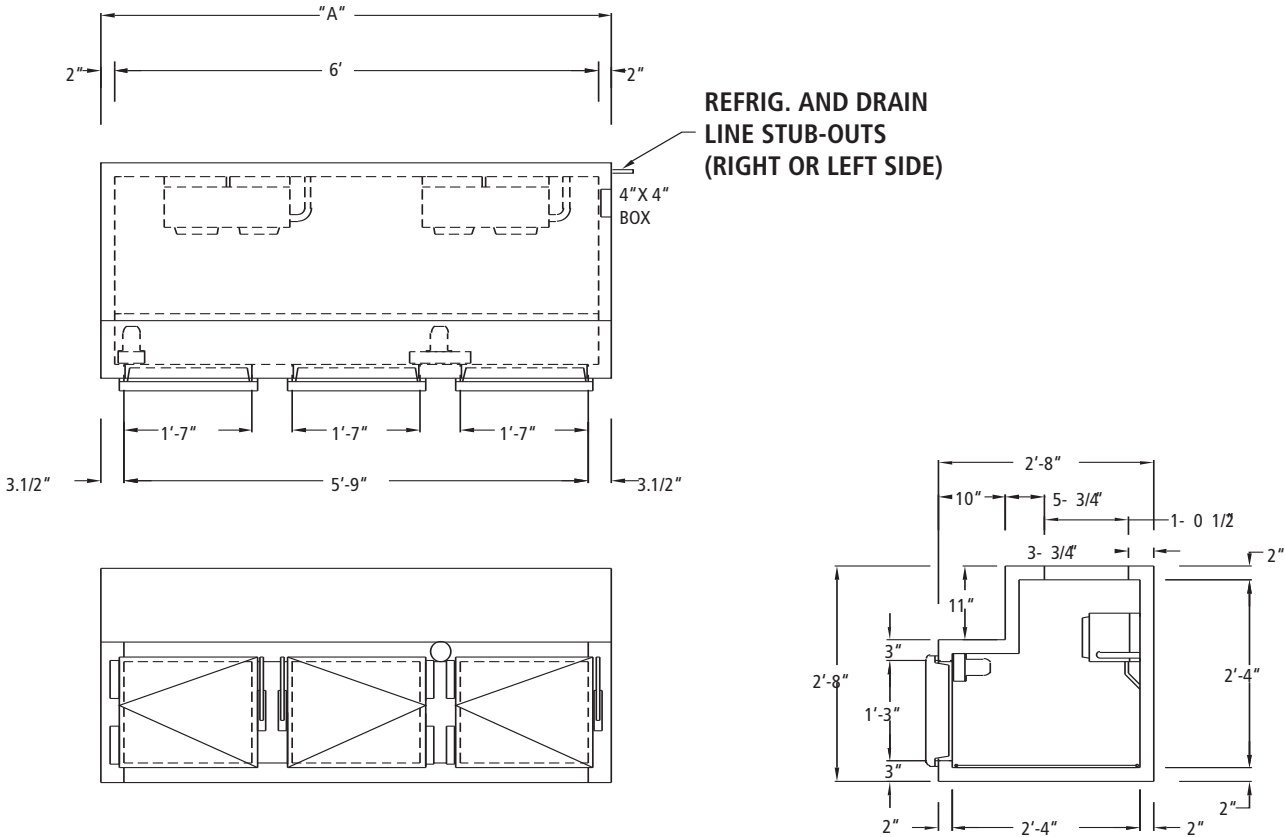

## PLATE SHELF REFRIGERATORS 32" BODY HEIGHT

SELF CONTAINED ALL DOORS								
MODEL	DIMENSION 'A'	H.P	VOLTS	AMPS	PHASE	BTU'S	WEIGHT	CUBE
IPRS-1-02	51"	1/4 HP	115v	8.6	1ph	1000	555	46
IPRS-2-04	81"	1/3 HP	115v	10	1ph	2000	720	71
IPRS-3-06	110"	1/2 HP	115v	13.9	1ph	3000	830	98
IPRS-4-08	139"	1/2 HP	115v	13.9	1ph	3000	940	119

REMOTE UNITS ALL DOORS								
MODEL	DIMENSION 'A'	VOLTS	AMPS	PHASE	BTU'S	WEIGHT	CUBE	
IPRR-1-02	33.1/2"	115v	1	1ph	1000	325	31	
IPRR-2-04	63"	115v	2	1ph	2000	455	56	
IPRR-3-06	92"	115v	3	1ph	3000	575	77	
IPRR-4-08	121"	115v	3	1ph	3000	665	104	